

ADDITIONAL PLAN

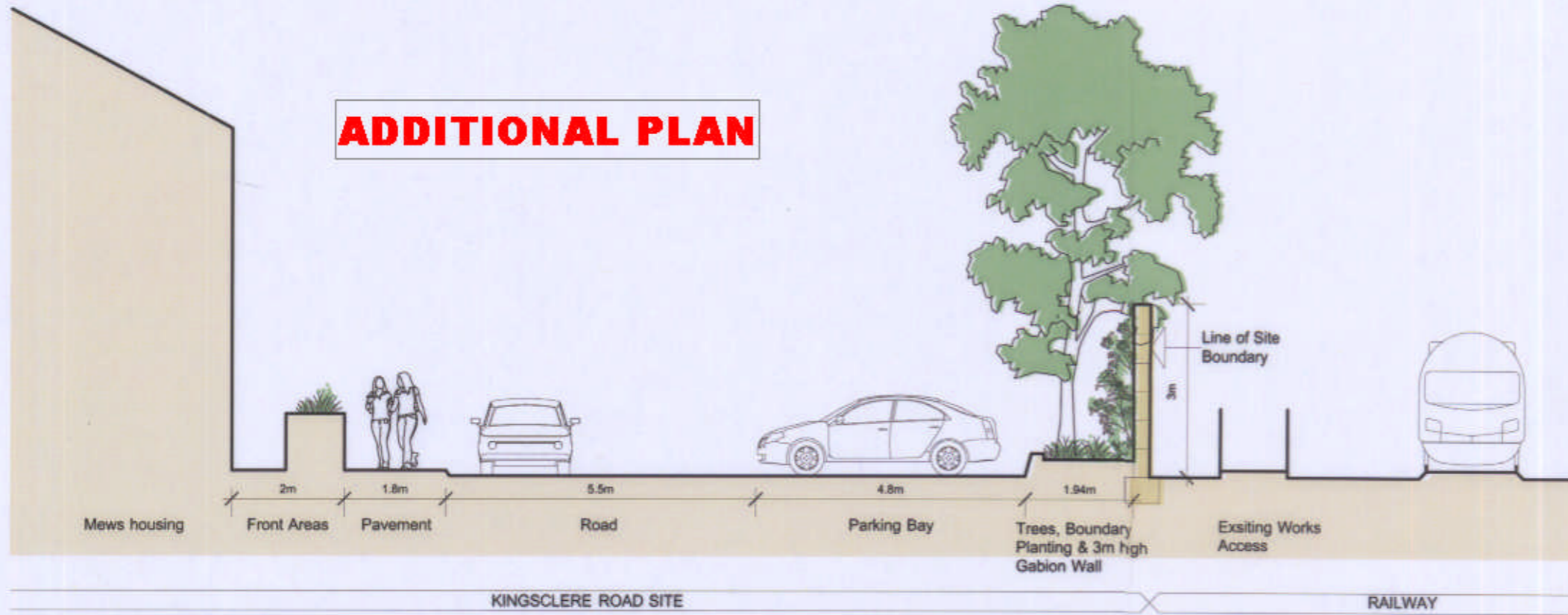

Detailed Section AA Through Southern Boundary

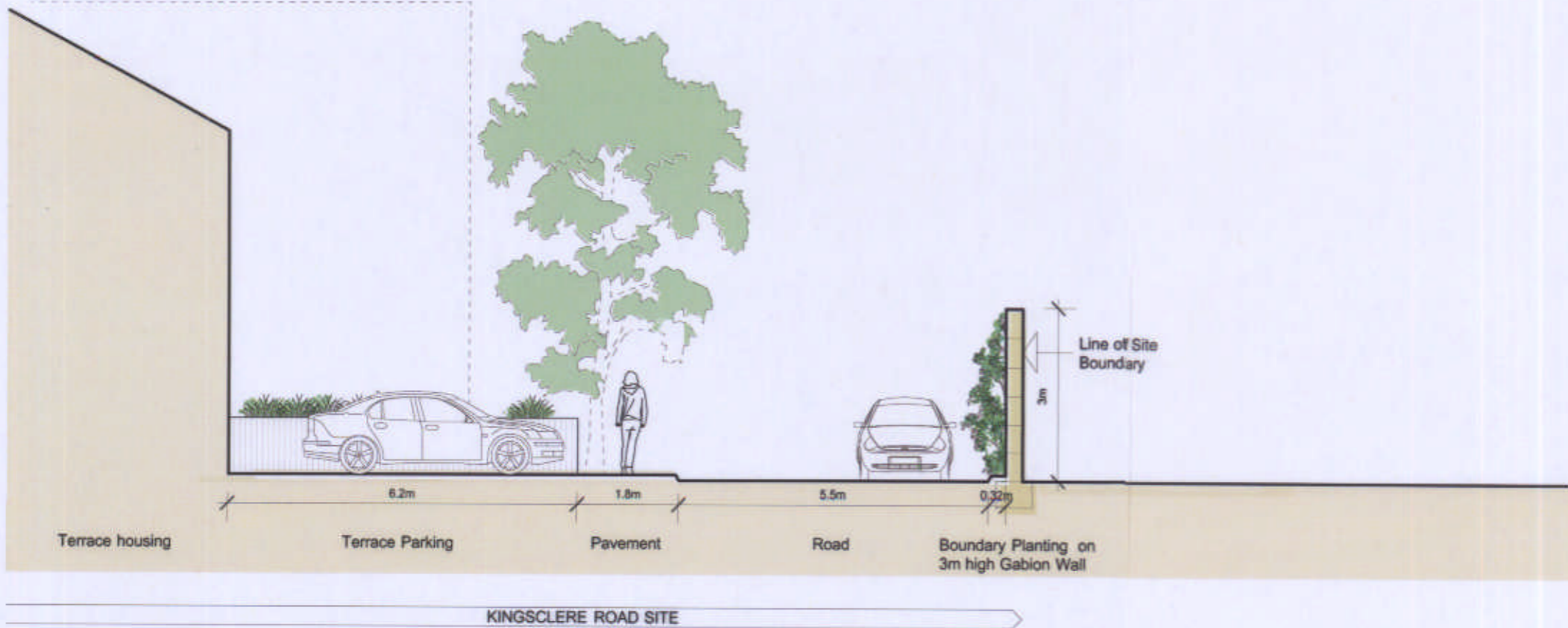

Detailed Section BB Through Western Boundary



Gabion Wall

Steel-welded gabion baskets are very robust wire mesh rock-filled baskets primarily used as retaining walls. Their characteristic rigidity makes these baskets particularly suitable for high and freestanding structures.

This product has a very natural appearance and enables you to create a distinctive freestanding

landscape feature in any garden. It provides an attractive rock-filled retaining wall and can create the illusion from a distance of a vertical column or wall of rock. The natural rock fill blends beautifully with most landscapes and vegetation can be established to grow over or through the baskets. Some plants can be successfully planted within the mesh baskets.

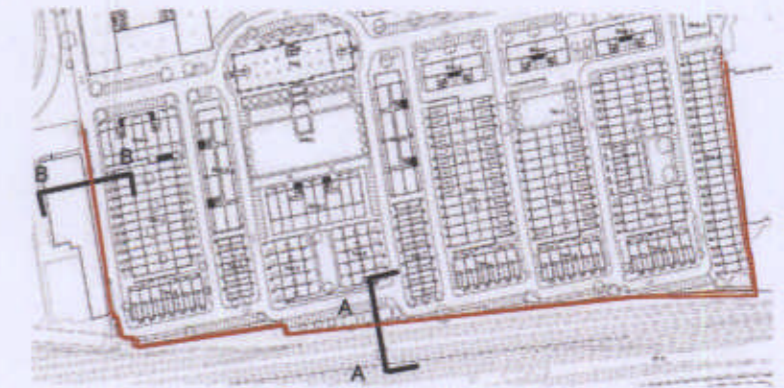

Key Plan showing Gabion wall (coloured Line)

Use figured dimensions only. Do not scale. IF IN DOUBT ASK

© 3W Architecture Limited. All rights reserved.

3W Architecture Limited registered in England.

Company no. 3132871 Registered Office The Pines Boars Head East Sussex

Rev	Date	Amendment
A	30.01.09	Issued for comment
B	06.02.09	Outline Planning Application

Date :	1:100
Scale @ A1	Checked SB
1:100	SB

Status	Planning
--------	----------

Architect
3W Thames Wharf Studios Rainville Road London W6 9HA tel. 020 7835 5552 fax. 020 7835 5525 email. mail@3W.org

Project :	Mixed Used Development, Basingstoke
Title	Detailed Boundary Section of Gabion Wall
Drwg. no.	126(12)125

Job Ref.	ELB	Job no.	126
Rev.	B		

